

Configuration diagramme

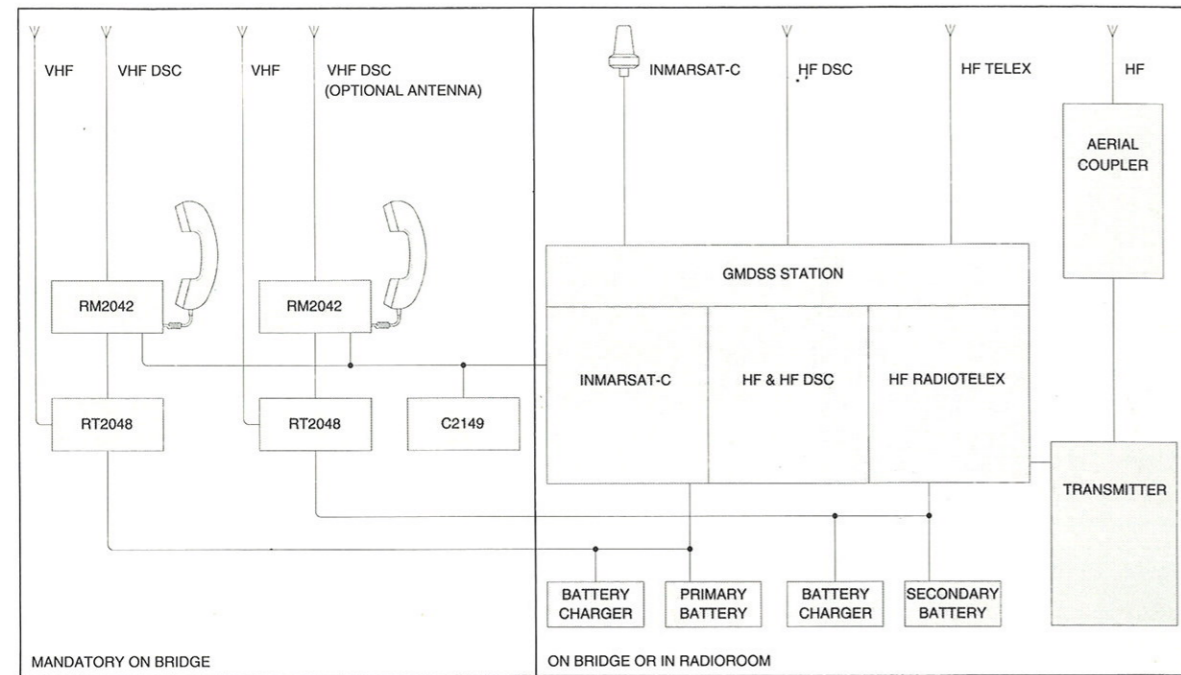

Dimensional drawing

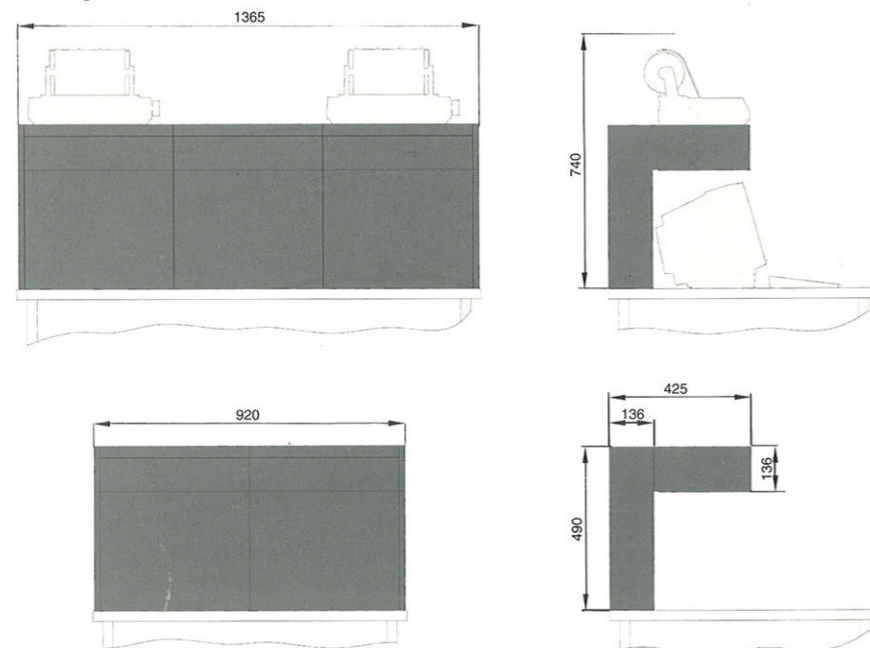

All specifications are subject to change without further notice.



S.P. RADIO A/S

DK-9200 AALBORG SV · DENMARK
PHONE INT.: +45 98 18 09 99
TELEX: 69 789 SPRAD DK
TELEFAX INT.: +45 98 18 67 17

SAILOR COMPACT GMDSS STATION

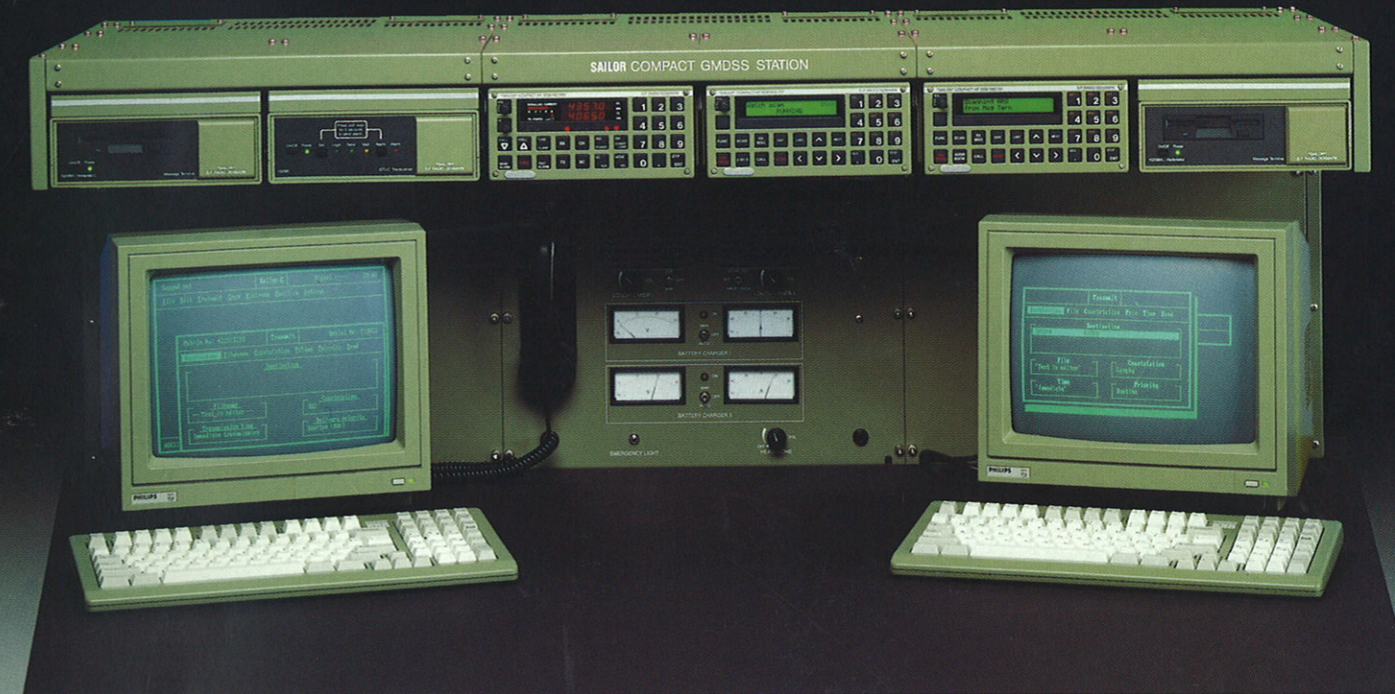

MODULAR INTEGRATED STATION

Developed and produced by S.P. RADIO A/S, Denmark -
Europe's leading manufacturer of maritime radio communication equipment

The SAILOR COMPACT GMDSS STATION - with an ingenious and flexible rack system and the well-known units from the SAILOR Compact 2000 programme - fulfils GMDSS communication requirements for all areas of operation, A1, A2, A3, A4. The SAILOR COMPACT GMDSS STATION is designed for tabletop or bulkhead mounting, and is therefore easy to mount on any vessel, whether it is an installation on board a newbuilding or for retrofit.

With a SAILOR COMPACT GMDSS STATION a large part of the work is carried out ashore. Power supplies, loudspeakers, remote indicator for battery charger, cables, plugs and mounting brackets are included from the factory - all this means that the installation time on board is minimized.

SAILOR COMPACT GMDSS STATION
S.P. RADIO A/S · AALBORG · DENMARK



SAILOR COMPACT GMDSS STATION

- designed for full compliance with all communication requirements within GMDSS for all areas: A1, A2, A3 and A4.

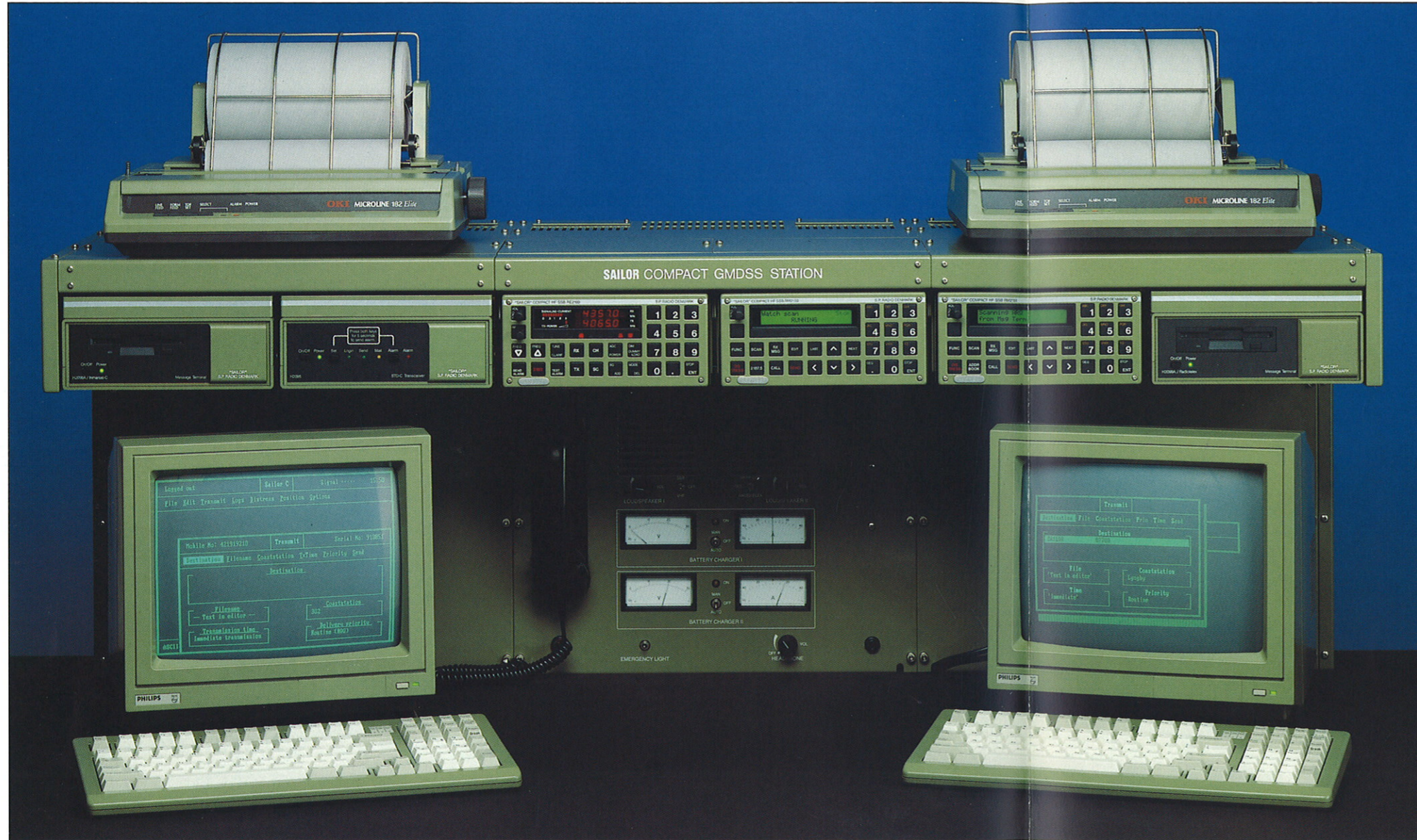

Tabletop mounted SAILOR COMPACT GMDSS STATION for area A3 with duplication.

According to IMO all vessels are allowed to sail without a radio officer from the 1st February 1992, if the vessel fulfils the GMDSS requirements*. Not later than 1999, all merchant vessels above 300 GRT and all passenger vessels must be equipped according to GMDSS, regardless of type and area of operation. However, SAILOR is already able to offer a GMDSS-solution allowing both existing vessels and newbuildings to benefit from the new possibilities.

*Described in "Amendments to the 1974 SOLAS Convention concerning Radio Communications for the Global Maritime Distress and Safety System".

S.P. Radio A/S has designed and developed a modular-built product programme which fulfils the requirements of IMO for communication equipment within GMDSS. In order to ensure a fast and cost-saving installation, the SAILOR products can be mounted in the SAILOR COMPACT GMDSS STATION. The station fulfils the requirements of all vessels in any area of operation A1, A2, A3 and A4. The SAILOR COMPACT GMDSS STATION is adaptable to any additional requirements from national authorities.

SAILOR Area Configuration



For operation in area A1

- 2 VHF Radiotelephones RT2048
- 2 VHF DSC and CH 70 WR RM2042

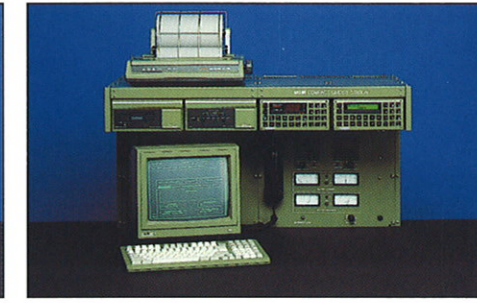

For operation in area A2

- 1 VHF Radiotelephone RT2048
- 1 VHF DSC and CH 70 WR RM2042
- 1 MF/HF Radiotelephone RE2100
- 1 MF/HF DSC and WR RM2150
- 1 Inmarsat-C with EGC H2095B

General notes to the above configurations

1. The VHF and VHF DSC/CH 70 watchkeeping receiver can be integrated in the GMDSS station or placed separately on the bridge according to national or individual requirements.
2. The VHF RT2048 is simplex/semi-duplex. For full duplex it may be replaced by VHF RT2047.
3. The following transmitter options are available for the MF/HF radiotelephone: 250 - 600 - 1200 Watt PEP.
4. Transmitter and power supply for MF/HF SSB can be mounted anywhere as hide away units. Aerial coupler must be mounted above deck.
5. For area A3 and A4, duplication has been chosen as one of the options for fulfilling the GMDSS maintenance requirements.
6. For the areas A1, A2, A3 and A4, the following equipment is required in addition to the above in order to fulfill GMDSS:

- 2182 kHz Watchkeeping Receiver SAILOR R501.
- Portable VHF SAILOR SP3000
- Navtex Receiver
- Satellite EPIRB
- Radar Transponder



To ensure simple and fast installation and service all cables and connections are assembled in a central connection box. Access to this connection box is quick and easy from the front of the station.



Shore-based maintenance is a natural part of GMDSS. A fast and efficient service is attained by replacing modules or units instead of carrying out repairs on site. The units in the SAILOR COMPACT GMDSS STATION can be easily replaced by means of standard tools, it only takes a few minutes.

SAILOR COMPACT GMDSS STA

- designed for full compliance with all communication requirements within GMDSS for all areas: A1, A2

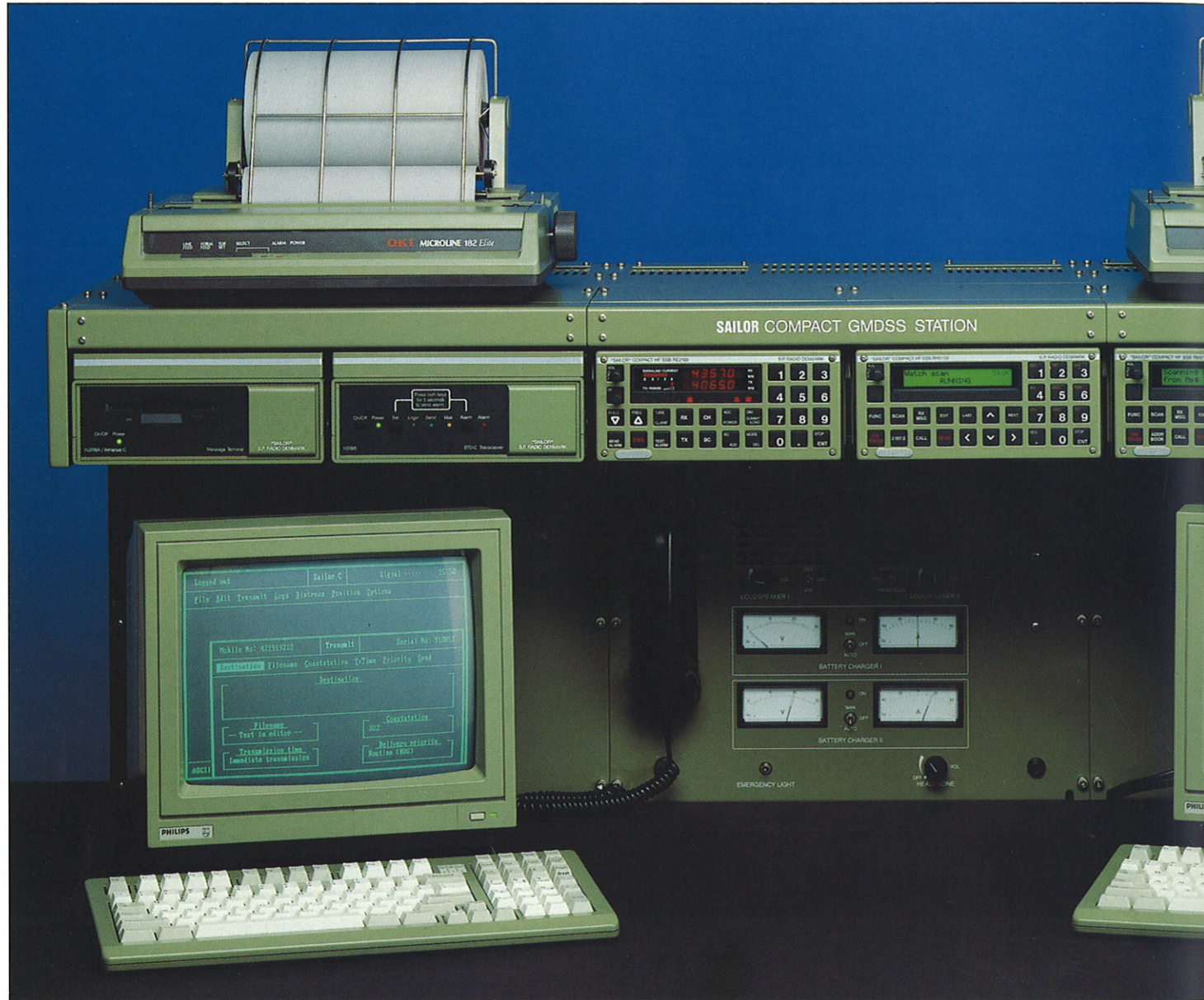

Tabletop mounted SAILOR COMPACT GMDSS STATION for area A3 with duplication.

According to IMO all vessels are allowed to sail without a radio officer from the 1st February 1992, if the vessel fulfils the GMDSS requirements*.

Not later than 1999, all merchant vessels above 300 GRT and all passenger vessels must be equipped according to GMDSS, regardless of type and area of operation.

However, SAILOR is already able to offer a GMDSS-solution allowing both existing vessels and newbuildings to benefit from the new possibilities.

S.P. Radio A/S has designed and developed a modular-built product programme which fulfils the requirements of IMO for communication equipment within GMDSS.

In order to ensure a fast and cost-saving installation, the SAILOR products can be mounted in the SAILOR COMPACT GMDSS STATION.

The station fulfils the requirements of all vessels in any area of operation A1, A2, A3 and A4.

The SAILOR COMPACT GMDSS STATION is adaptable to any additional requirements from national authorities.

*Described in "Amendments to the 1974 SOLAS Convention concerning Radio Communications for the Global Maritime Distress and Safety System".

The GMDSS Solution for all Vessels

The SAILOR COMPACT GMDSS STATION is designed for tabletop or bulkhead mounting, and is therefore easy to install on board any vessel, whether it is an installation on board a newbuilding or for retrofit.

The installation time is especially important in connection with retrofit. With a SAILOR COMPACT GMDSS STATION a large part of the work can be carried out ashore.

Power supplies, loudspeakers, remote indicator for battery charger, interconnection cables and mounting brackets are included from the factory - all this means that the installation time on board is minimized.

- Modular, compact and flexible
- Tabletop or bulkhead mounting
- Suitable for retrofit and newbuildings
- Covers all areas of operation and all types of vessels
- Can be adapted to individual requirements
- Prepared for the future and easy to operate
- Meets future demands for integrated bridge systems
- Ensures fast, cost-saving, and correct installation
- Delivered with all installation materials and internal connection cables

ations:

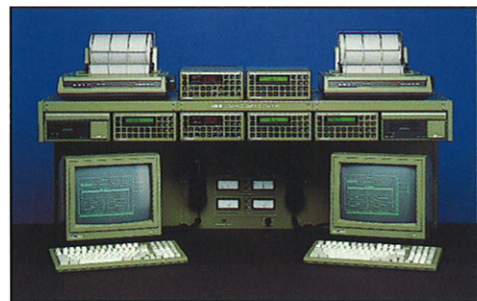
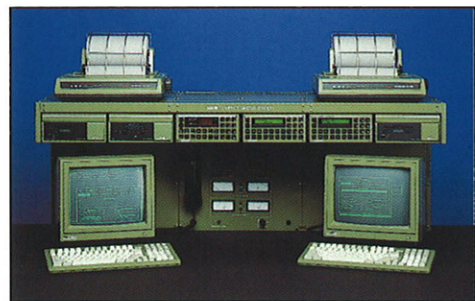

For operation in area A3 and occasionally in area A4 with duplication

- 2 VHF Radiotelephones RT2048
- 2 VHF DSC and CH 70 WR RM2042
- 1 MF/HF Radiotelephone RE2100
- 1 MF/HF DSC and WR RM2150
- 1 MF/HF Radiotelex (NBDP) RM2151
- 1 Inmarsat-C with EGC H2095B

For frequent operation in area A4 with duplication

- 2 VHF Radiotelephones RT2048
- 2 VHF DSC and CH 70 WR RM2042
- 2 MF/HF Radiotelephones RE2100
- 1 MF/HF DSC and WR RM2150
- 2 MF/HF Radiotelex (NBDP) RM2151

Area definition

- Area A1 Within coverage of coast station with VHF DSC.
- Area A2 Outside A1, but within coverage of coast station with MF DSC.
- Area A3 Outside A1 and A2, but within coverage of the Inmarsat satellites.
- Area A4 Outside A1, A2 and A3. Polar regions.

GMDSS implementation plan

- 1st February 1992 Voluntary installation of GMDSS.
- 1st February 1995 Mandatory installation of GMDSS for newbuildings above 300 GRT and all passenger vessels.
- 1st February 1999 Mandatory installation of GMDSS for all vessels above 300 GRT and all passenger vessels.

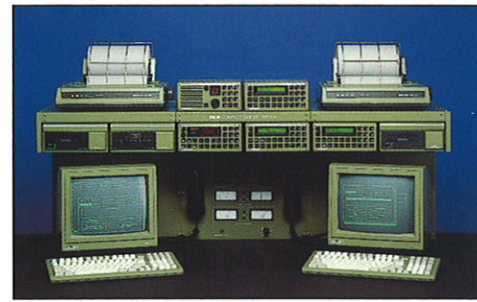

In order to simplify the transmission of distress signals, a central GMDSS Alarm Unit C2149 can be placed at the conning position. From this unit the distress alarm on VHF DSC, MF/HF DSC and Inmarsat-C is activated with one push. The SAILOR C2149 will also indicate received distress signals by sound and display read-out.

The SAILOR COMPACT GMDSS STATION is prepared for the future. Extra modules can at any time be easily added to the original configuration and in this way adapted to individual requests or different national requirements.

SAILOR COMPACT GMDSS STATION



MODULAR INTEGRATED STATION

Developed and produced by S.P. RADIO A/S, Denmark - Europe's leading manufacturer of maritime radio communication equipment

The SAILOR COMPACT GMDSS STATION - with an ingenious and flexible rack system and the well-known units from the SAILOR Compact 2000 programme - fulfils GMDSS communication requirements for all areas of operation, A1, A2, A3, A4. The SAILOR COMPACT GMDSS STATION is designed for tabletop or bulkhead mounting, and is therefore easy to mount on any vessel, whether it is an installation on board a newbuilding or for retrofit.

With a SAILOR COMPACT GMDSS STATION a large part of the work is carried out ashore. Power supplies, loudspeakers, remote indicator for battery charger, cables, plugs and mounting brackets are included from the factory - all this means that the installation time on board is minimized.

SAILOR COMPACT GMDSS STATION
S.P. RADIO A/S · AALBORG · DENMARK

